

Production Worksheet

Wilcom EmbroideryStudio – Designing



Stitches: 9,325
 Height: 74.4 mm
 Width: 120.5 mm
 Colors: 3
 Colorway: Gunold Poly40
 Zoom: 1:1

Design: n°06290159151 _11-49-34_debrais brod

Title: n°06290159151 _11-49-34_debrais brod

Machine format: Tajima
 Color changes: 4
 Stops: 5
 Trims: 28
 Appliqués: 0
 Left: 60.2 mm
 Right: 60.2 mm
 Up: 37.2 mm
 Down: 37.2 mm
 EndX: 0.0 mm
 EndY: 0.0 mm
 Area: 8969.9 mm²
 Max stitch: 9.0 mm
 Min stitch: 0.1 mm
 Max jump: 6.9 mm
 Total thread: 45.69m
 Total bobbin: 15.73m

Stop Sequence:

#	N#	Color	St.	Code	Name	Chart
1.	4		1,363	61367	Gunold Poly40	
2.	1		2,465	61001	Gunold Poly40	
3.	2		805	61005	Gunold Poly40	
4.	4		3,512	61367	Gunold Poly40	
5.	2		1,178	61005	Gunold Poly40	



ENTREPRISE DEBRAIS
POSEUR CUISINES

Color Film

Wilcom EmbroideryStudio – Designing



Stitches: 9,325
Height: 74.4 mm
Width: 120.5 mm
Colors: 3
Colorway: Gunold Poly40
Zoom: 0.39

Design: **n°06290159151 _11-49-34_debrais brod**

Title: **n°06290159151 _11-49-34_debrais brod**

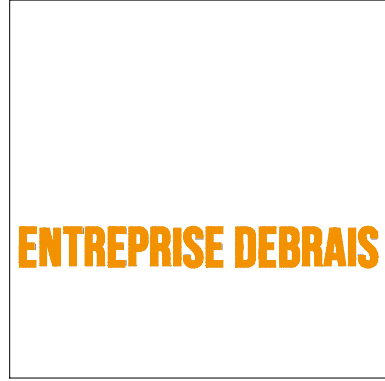
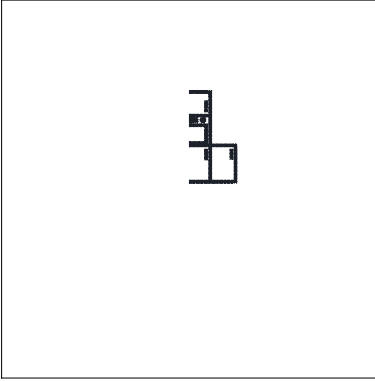
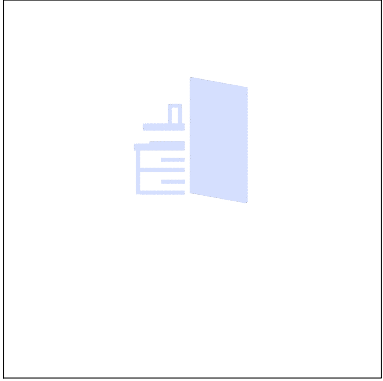
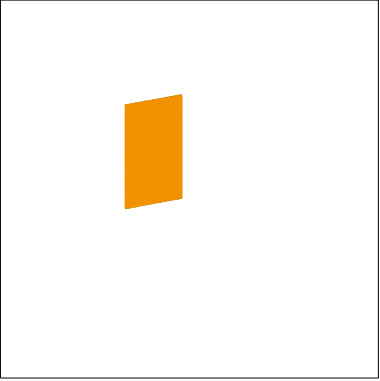

Color: 4
Stop: 1
Element:
Code: 61367
Name:
Chart: Gunold Poly40
Stitches: 1,363
Thread used: 8.17m

Color: 1
Stop: 2
Element:
Code: 61001
Name:
Chart: Gunold Poly40
Stitches: 2,465
Thread used: 12.59m

Color: 2
Stop: 3
Element:
Code: 61005
Name:
Chart: Gunold Poly40
Stitches: 805
Thread used: 2.91m

Color: 4
Stop: 4
Element:
Code: 61367
Name:
Chart: Gunold Poly40
Stitches: 3,512
Thread used: 17.19m

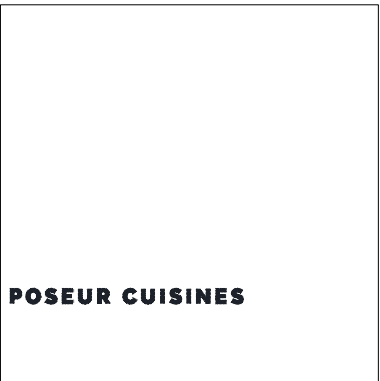

Color: 2
Stop: 5
Element:
Code: 61005
Name:
Chart: Gunold Poly40
Stitches: 1,178
Thread used: 4.32m